

SENECA PARK ^{1.5 and 2.0} MILE CROSS COUNTRY COURSES

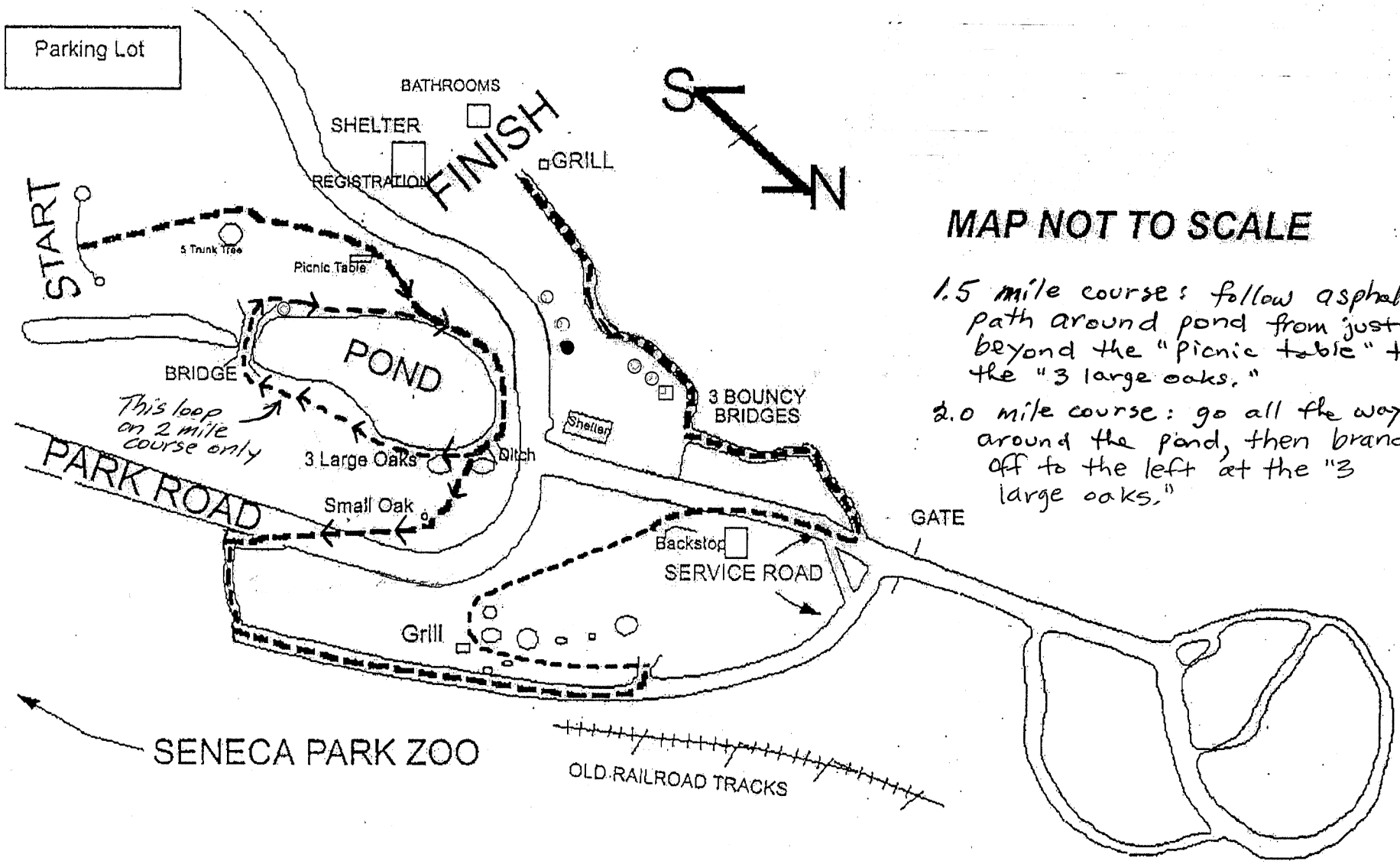

MAP NOT TO SCALE

1.5 mile course: follow asphalt path around pond from just beyond the "picnic table" + the "3 large oaks."

2.0 mile course: go all the way around the pond, then branch off to the left at the "3 large oaks."

This loop on 2 mile course only

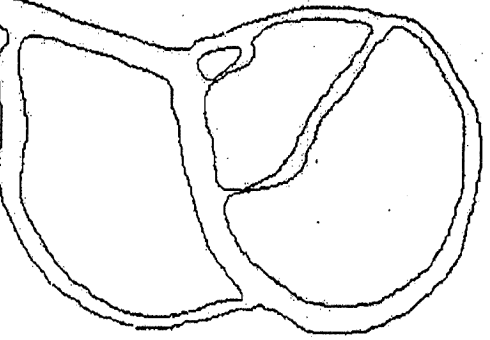

Revised by: *E* 9-11-07
E 9-4-08